

- OPTION 3
- Brickwork clad with white timber featheredged weatherboard;
 - Existing brickwork columns retained;
 - Changing Rooms reconfigured;
 - EAGCC moved changing rooms to offer access to the bar area, the away team are required to exit to the outside first before entering the bar;
 - Equipment store added within Ground keepers storage area.

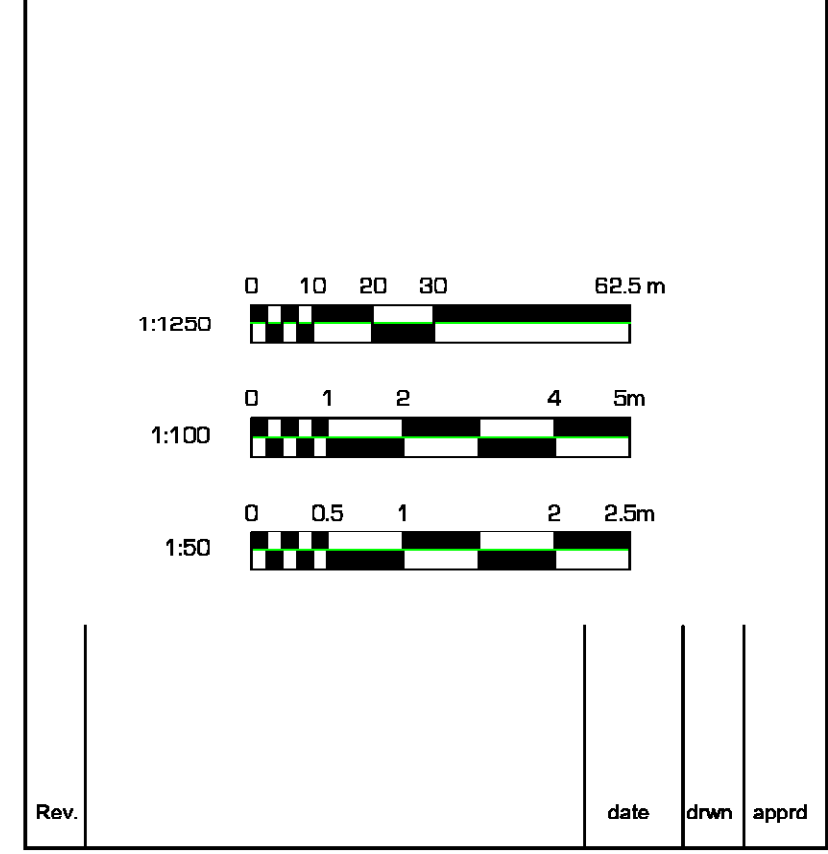
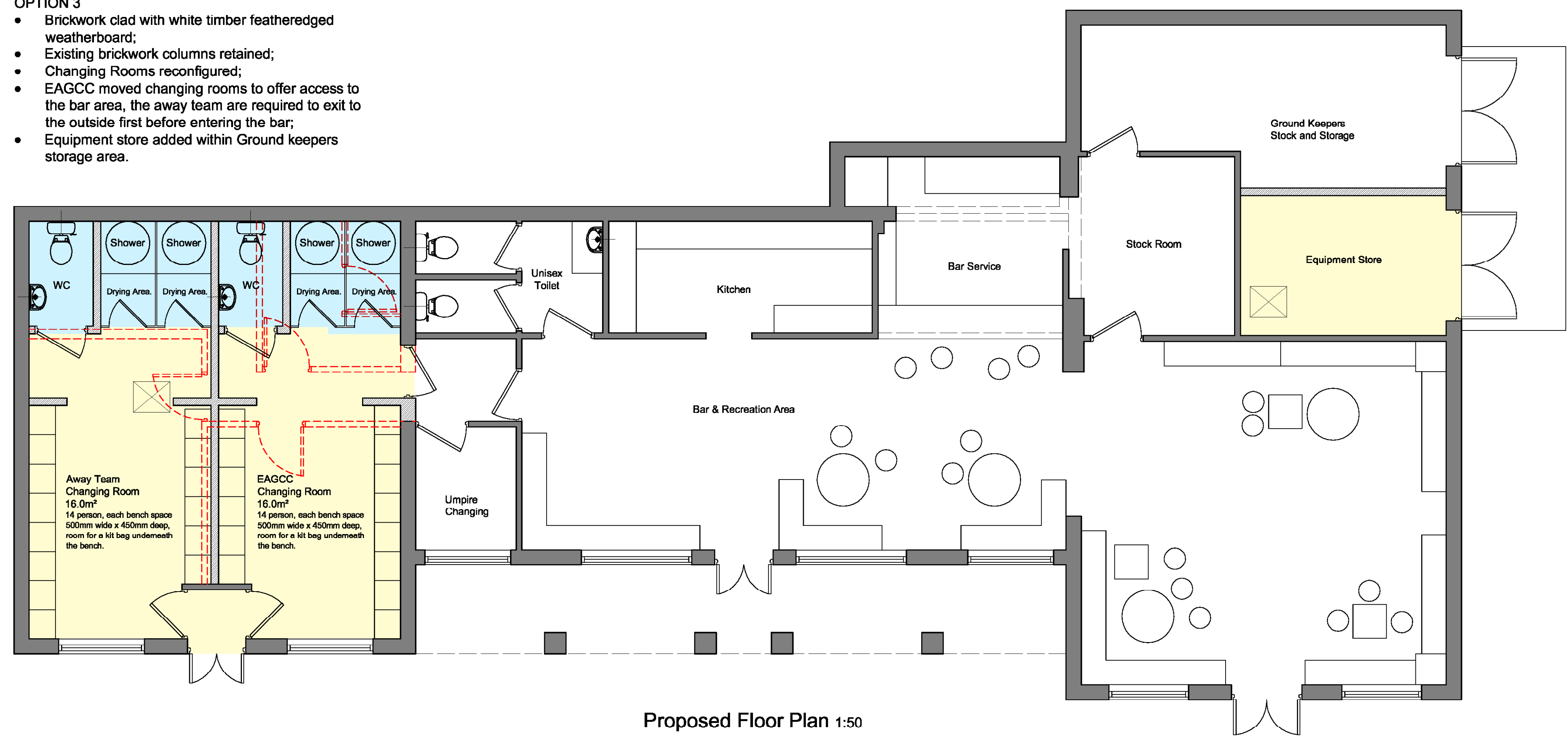

Client
EIGHT ASH GREEN CRICKET CLUB

Project
PROPOSED INTERNAL ALTERATIONS AND NEW CLADDING TO EIGHT ASH GREEN CRICKET CLUB, SPRING LANE, EIGHT ASH GREEN, COLCHESTER CO3 9TG.

Subject
PLANS AND ELEVATIONS AS PROPOSED OPTION 3

Scale 1:50; 1:100; 1:1250	Sheet Size A1 Approved	Drawn SJH Date SEP 23
---------------------------------	------------------------------	--------------------------------

Project Ref. / Drawing No.	9 2 5 2 . 0 0 4	Revision
----------------------------	-----------------	----------